

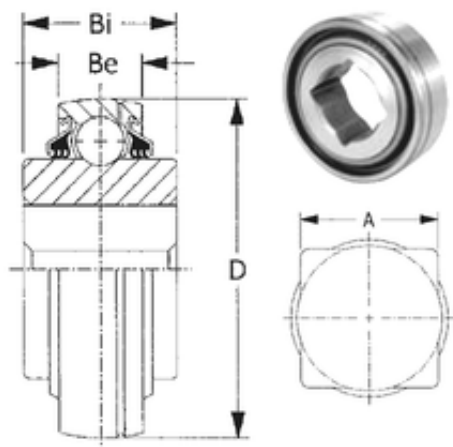

NACHI BEARINGS TRAINING INDUSTRY



31,75 mm x 85 mm x 36,52 mm CYSD
GW209PPB8 deep groove ball bearings

Bearing No. GW209PPB8

Size	31.75x85x36.52 mm
Bore Diameter	31,75 mm
Outer Diameter	85 mm
Width	36,52 mm
d	31,75 mm
D	85 mm
B	36,52 mm
C	22 mm
Be	22 mm
Bi	36,52 mm

GW209PPB8 Bearing 2D drawings and 3D CAD models