

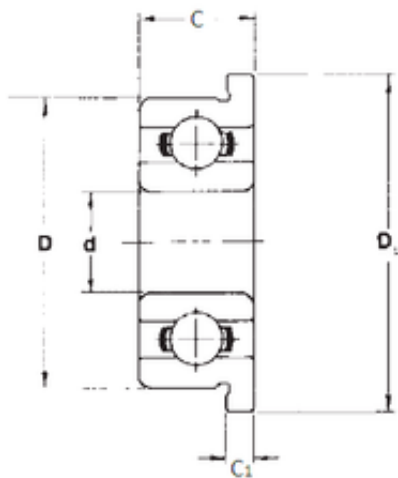

# NACHI BEARINGS TRAINING INDUSTRY



5 mm x 8 mm x 2 mm FBJ MF85 deep groove ball bearings

Bearing No. MF85

Size	5x8x2 mm
Bore Diameter	5 mm
Outer Diameter	8 mm
Width	2 mm
d	5 mm
D	8 mm
D1	9,2 mm
B	2 mm
C	2 mm
B1	0,6 mm
Weight	0,00033 Kg
Basic dynamic load rating (C)	0,304 kN
Basic static load rating (C0)	0,118 kN
(Grease) Lubrication Speed	53000 r/min

MF85 Bearing 2D drawings and 3D CAD models