

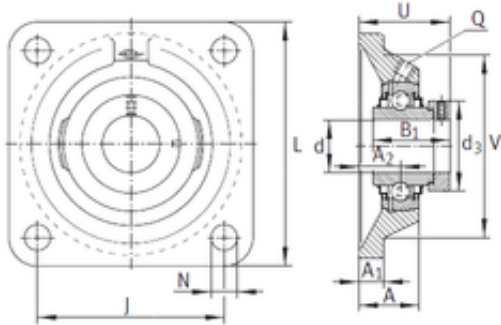

NACHI BEARINGS TRAINING INDUSTRY

INA RCJO30 bearing units



Bearing No. RCJO30

Bore Diameter	30 mm
d	30 mm
V	98 mm
U	53,1 mm
Thread (Q)	Rp1/8
d3	51 mm
A	30,6 mm
A1	15 mm
B1	50 mm
J	95 mm
L	125 mm
N	14,5 mm
A2	20,6 mm
Weight	1,75 Kg
Basic dynamic load rating (C)	29,5 kN
Category	Bearings
Inventory	0.0
Manufacturer Name	SCHAEFFLER GROUP
Minimum Buy Quantity	N/A
Weight / Kilogram	1.75
Product Group	M06110

RCJO30 Bearing 2D drawings and 3D CAD models