

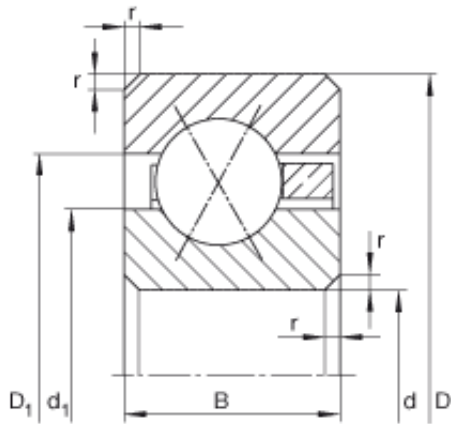

NACHI BEARINGS TRAINING INDUSTRY



10 inch x 292,1 mm x 19,05 mm INA CSXF100 deep groove ball bearings

Bearing No. CSXF100

Size	254x292.1x19.05 mm
Bore Diameter	254 mm
Outer Diameter	292,1 mm
Width	19,05 mm
d	254 mm
d	10 inch
D	292,1 mm
B	19,05 mm
D ₁	278 mm
d ₁	268,1 mm
r _{min}	2 mm
m	1,95 kg / Weight
C _r	43000 N / Dynamic load rating (radial)
C _{0r}	84000 N / Static load rating (radial)

CSXF100 Bearing 2D drawings and 3D CAD models