

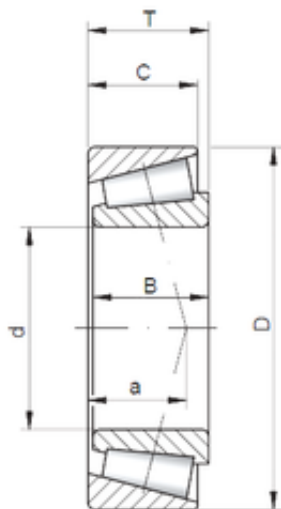

NACHI BEARINGS TRAINING INDUSTRY



26,988 mm x 60,325 mm x 17,462 mm ISO
15580/15523 tapered roller bearings

Bearing No. 15580/15523

Size	26.988x60.325x19.842 mm
Bore Diameter	26,988 mm
Outer Diameter	60,325 mm
Width	19,842 mm
d	26,988 mm
D	60,325 mm
T	19,842 mm
B	17,462 mm
C	15,875 mm
a	5,1 mm

15580/15523 Bearing 2D drawings and 3D CAD models