

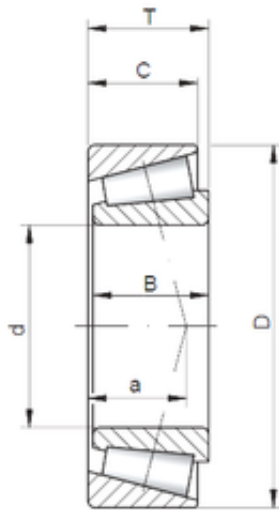

# NACHI BEARINGS TRAINING INDUSTRY



65 mm x 110 mm x 31 mm ISO JD6549/10 tapered roller bearings

Bearing No. JD6549/10

Size	65x110x31 mm
Bore Diameter	65 mm
Outer Diameter	110 mm
Width	31 mm
d	65 mm
D	110 mm
T	31 mm
B	31 mm
C	25 mm
a	7,6 mm

JD6549/10 Bearing 2D drawings and 3D CAD models