

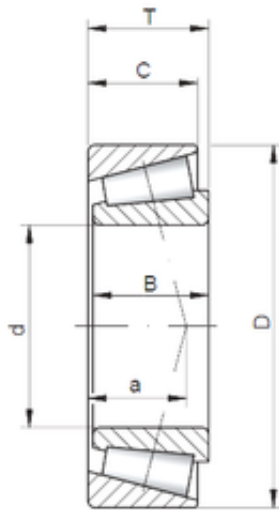

NACHI BEARINGS TRAINING INDUSTRY



165,1 mm x 215,9 mm x 26,195 mm ISO
L433749/10 tapered roller bearings

Bearing No. L433749/10

Size	165.1x215.9x26.195 mm
Bore Diameter	165,1 mm
Outer Diameter	215,9 mm
Width	26,195 mm
d	165,1 mm
D	215,9 mm
T	26,195 mm
B	26,195 mm
C	19,05 mm
a	8,6 mm

L433749/10 Bearing 2D drawings and 3D CAD models