

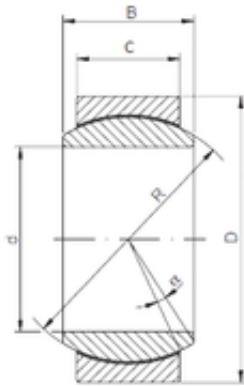

NACHI BEARINGS TRAINING INDUSTRY



220 mm x 320 mm x 135 mm ISO GE 220
ECR-2RS plain bearings

Bearing No. GE 220 ECR-2RS

Size	220x320x135 mm
Bore Diameter	220 mm
Outer Diameter	320 mm
Width	135 mm
d	220 mm
D	320 mm
B	135 mm
C	100 mm
R	275 mm
Angle	8 °

GE 220 ECR-2RS Bearing 2D drawings and 3D CAD models