

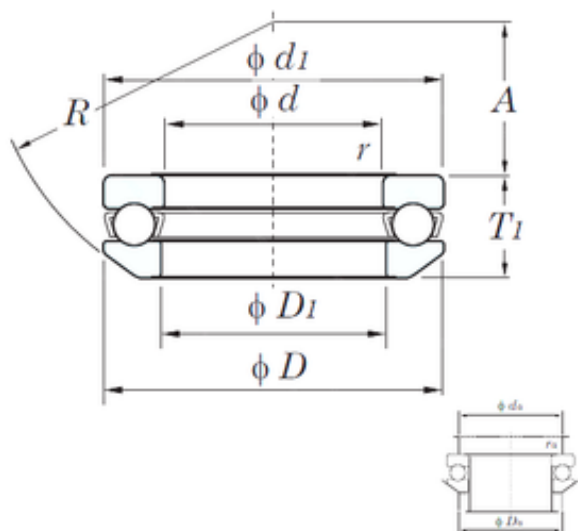

# NACHI BEARINGS TRAINING INDUSTRY



## KOYO 53411 thrust ball bearings

Bearing No. 53411

|                               |                |
|-------------------------------|----------------|
| Size                          | 55x120x50.5 mm |
| Bore Diameter                 | 55 mm          |
| Outer Diameter                | 120 mm         |
| Width                         | 50,5 mm        |
| d                             | 55 mm          |
| D                             | 120 mm         |
| T1                            | 50,5 mm        |
| d1                            | 120 mm         |
| r min.                        | 1,5 mm         |
| A                             | 28 mm          |
| D1                            | 57 mm          |
| R                             | 90 mm          |
| da min.                       | 94 mm          |
| Da max.                       | 81 mm          |
| ra max.                       | 1,5 mm         |
| Weight                        | 2,57 Kg        |
| Basic dynamic load rating (C) | 178 kN         |
| Basic static load rating (C0) | 359 kN         |
| (Grease) Lubrication Speed    | 1200 r/min     |
| Bearing No.                   | 53411          |
| T                             | 50.5           |
| r(min)                        | 1.5            |
| Ca                            | 223            |
| Coa                           | 359            |
| Cu                            | 16.2           |
| Grease lub.                   | 1200           |

53411 Bearing 2D drawings and 3D CAD models



## NACHI BEARINGS TRAINING INDUSTRY

|                  |      |
|------------------|------|
| Oil lub.         | 1900 |
| d1(max)          | 120  |
| D1(min)          | 57   |
| D2(min)          | -    |
| D3(min)          | -    |
| C                | -    |
| da(min)          | 94   |
| Da(max)          | 81   |
| ra(max)          | 1.5  |
| (Refer.)Mass(kg) | 2.57 |