

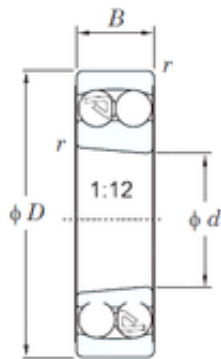

# NACHI BEARINGS TRAINING INDUSTRY



45 mm x 100 mm x 25 mm KOYO 1309K self aligning ball bearings

Bearing No. 1309K

1309K Bearing 2D drawings and 3D CAD models

Size	45x100x25 mm
Bore Diameter	45 mm
Outer Diameter	100 mm
Width	25 mm
d	45 mm
D	100 mm
B	25 mm
C	25 mm
r min.	1.5 mm
da min.	53 mm
Da max.	92 mm
ra max.	1.5 mm
Weight	0.942 Kg
Basic dynamic load rating (C)	38.1 kN
Basic static load rating (C0)	12.7 kN
(Grease) Lubrication Speed	6100 r/min
(Oil) Lubrication Speed	7500 r/min
Calculation factor (e)	0.25
Calculation factor (Y0)	2.68
Calculation factor (Y1)	2.56
Category	Self Aligning Ball Bearings
Inventory	0.0
Manufacturer Name	KOYO
Minimum Buy Quantity	N/A
Weight / Kilogram	1.018



## NACHI BEARINGS TRAINING INDUSTRY

EAN	0605790001734
Product Group	B00152
Mounting Method	Tapered Adapter
Enclosure	Open
Rolling Element	Ball Bearing
Adapter Sleeve	H-309X
Cage Material	Steel
Precision Class	ABEC 1   ISO P0
Internal Clearance	C0-Medium
Number of Rows of Balls	Double Row
Other Features	Allowable Misalignment 3 Deg   1:12 Taper
Long Description	45MM Bore; Tapered Adapter Mount; 100MM Outside Diameter; 25MM Inner Race Width; 25MM Outer Race Width; Open; Steel Cage; Double Row of Balls; ABEC 1   ISO P0; C0-Medium
Inch - Metric	Metric
Category	Self Aligning Ball Bearings
UNSPSC	31171532
Harmonized Tariff Code	8482.10.50.68
Noun	Bearing
Keyword String	Self Aligning
Manufacturer URL	<a href="http://www.koyousa.com">http://www.koyousa.com</a>
Manufacturer Item Number	1309K
Weight / LBS	2.07675
Inner Race Width	0.984 Inch   25 Millimeter
Outside Diameter	3.937 Inch   100 Millimeter
Outer Race Width	0.984 Inch   25 Millimeter
Bore	1.772 Inch   45 Millimeter