

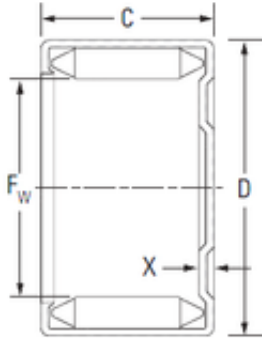

NACHI BEARINGS TRAINING INDUSTRY

KOYO M861 needle roller bearings



Bearing No. M861

Size	12.700x17.462x9.520 mm
Bore Diameter	12.700 mm
Outer Diameter	17.462 mm
Width	9.520 mm
Fw	12.700 mm
D	17.462 mm
C	9.520 mm
x	2.03 mm
b	7.3 mm
Weight	42,253 Kg
Basic dynamic load rating (C)	6.10 kN
Basic static load rating (C0)	10.1 kN

M861 Bearing 2D drawings and 3D CAD models