

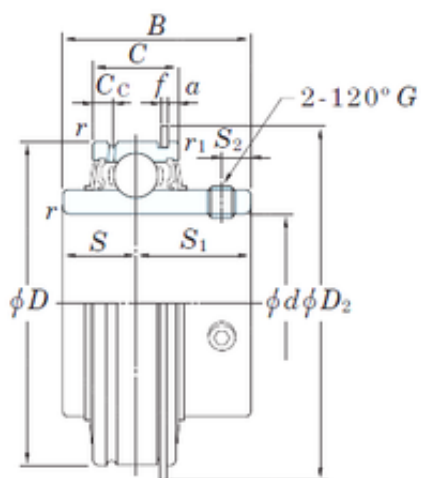

NACHI BEARINGS TRAINING INDUSTRY



50,8 mm x 100 mm x 55,6 mm KOYO
ER211-32 deep groove ball bearings

Bearing No. ER211-32

Size	50.8x100x55.6 mm
Bore Diameter	50,8 mm
Outer Diameter	100 mm
Width	55,6 mm
d	50,8 mm
D	100 mm
B	55,6 mm
C	30 mm
S1	33,4 mm
a	3,18 mm
f	2,41 mm
r min.	1,5 mm
r1 min.	0,5 mm
C	7,5 mm
D2	106,3 mm
S	22,2 mm
S2	9 mm
Thread (G) - 3/8-24UNF	3/824UNF
Weight	1,56 Kg
Basic dynamic load rating (C)	43,4 kN
Basic static load rating (C0)	29,4 kN

ER211-32 Bearing 2D drawings and 3D CAD models