

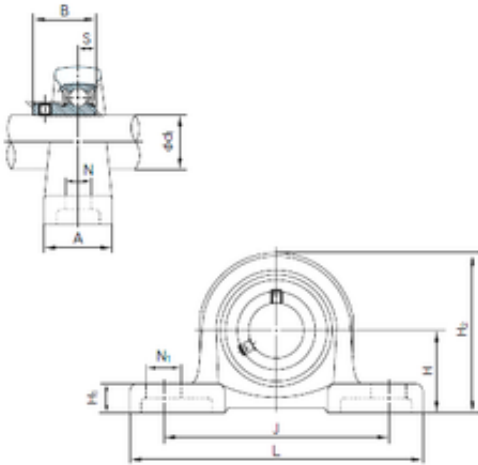

# NACHI BEARINGS TRAINING INDUSTRY

## NACHI BLLP2J bearing units

Bearing No. BLLP2J



BLLP2J Bearing 2D drawings and 3D CAD models

Bore Diameter	15 mm
Width	22 mm
d	15 mm
A	25 mm
B	22 mm
H	30.2 mm
H1	12 mm
H2	57 mm
J	87 mm
L	114 mm
N	12 mm
N1	16 mm
S	6 mm
Bolt (G)	M10