

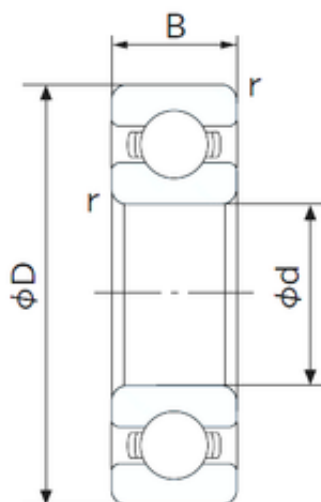

NACHI BEARINGS TRAINING INDUSTRY



260 mm x 360 mm x 46 mm NACHI 6952 deep groove ball bearings

Bearing No. 6952

6952 Bearing 2D drawings and 3D CAD models

Size	260x360x46 mm
Bore Diameter	260 mm
Outer Diameter	360 mm
Width	46 mm
d	260 mm
D	360 mm
B	46 mm
C	46 mm
r min.	2.1 mm
da min.	269 mm
Da max.	351 mm
ra max.	2.0 mm
Weight	13.4 Kg
Basic dynamic load rating (C)	204 kN
Basic static load rating (C0)	254 kN
(Grease) Lubrication Speed	1500 r/min
Enclosure	Open
Bore Type	Cylindrical Bore
Configuration	Single Row
Bore Size	260 mm
Outside Diameter	360 mm
Width	46 mm
Fillet Radius/Chamfer	2.1 mm
Dynamic Load Rating	204,000 N
Static Load Rating	254,000 N



NACHI BEARINGS TRAINING INDUSTRY

Limiting Speed - Grease	1,600 rpm
Limiting Speed - Oil	1,900 rpm
Factor f_0	16.4
Radial Clearance	0.035 to 0.105 mm
d_a (min)	269 mm
D_a (max)	351 mm
r_a (max)	2 mm