

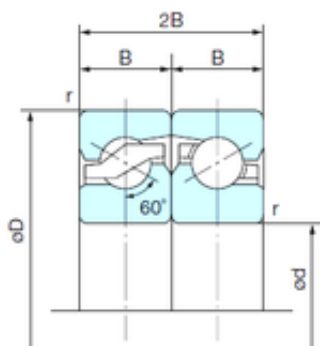

# NACHI BEARINGS TRAINING INDUSTRY

40 mm x 90 mm x 20 mm NACHI 40TAB09DF thrust ball bearings



Bearing No. 40TAB09DF

40TAB09DF Bearing 2D drawings and 3D CAD models

Size	40x90x20 mm
Bore Diameter	40 mm
Outer Diameter	90 mm
Width	20 mm
d	40 mm
D	90 mm
B	20 mm
C	20 mm
Angle ( )	60 °
r min.	1 mm
r1 min.	0.6 mm
2B	40 mm
Weight	0.62 Kg
Basic dynamic load rating (C)	65 kN
Basic static load rating (C0)	101 kN
Bore Type	Cylindrical Bore
Enclosure	Open
Configuration	Double Row
Bore Size	40 mm
Outside Diameter	90 mm
Width	20 mm
Fillet Radius/Chamfer	1 mm
r1	0.6 mm
Dynamic Load Rating	65,000 N
Static Load Rating	101,000 N



## NACHI BEARINGS TRAINING INDUSTRY

Limiting Speed - Grease	3,150 rpm
Limiting Speed - Oil	4,000 rpm
Starting Torque - Grease Lubrication	30 N · cm
da1 (min)	67.2 mm
da2 (min)	57.2 mm
Da1 (max)	67 mm
Da2 (max)	78.4 mm