

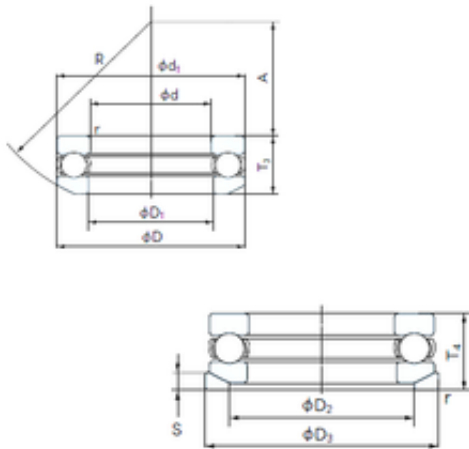

NACHI BEARINGS TRAINING INDUSTRY

NACHI 53234U thrust ball bearings

Bearing No. 53234U



53234U Bearing 2D drawings and 3D CAD models

Size	170x240x65 mm
Bore Diameter	170 mm
Outer Diameter	240 mm
Width	65 mm
d	170 mm
D	240 mm
T	65 mm
d1	237 mm
r min.	1.5 mm
A	91 mm
D1	173 mm
D2	200 mm
D3	250 mm
R	180 mm
S	21.5 mm
Weight	9.95 Kg
Basic dynamic load rating (C)	261 kN
Basic static load rating (C0)	835 kN
(Grease) Lubrication Speed	840 r/min