

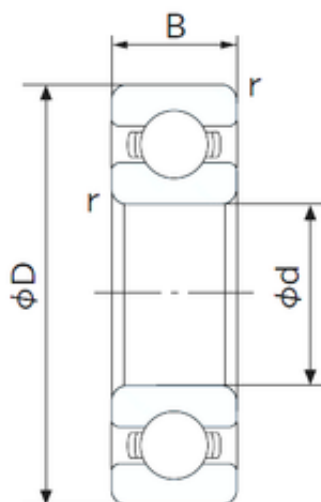

NACHI BEARINGS TRAINING INDUSTRY



190 mm x 340 mm x 55 mm NACHI 6238 deep groove ball bearings

Bearing No. 6238

Size	190x340x55 mm
Bore Diameter	190 mm
Outer Diameter	340 mm
Width	55 mm
d	190 mm
D	340 mm
B	55 mm
C	55 mm
r min.	4 mm
da min.	208 mm
Da max.	322 mm
ra max.	3.0 mm
Weight	23.0 Kg
Basic dynamic load rating (C)	255 kN
Basic static load rating (C0)	282 kN
(Grease) Lubrication Speed	1700 r/min
Enclosure	Open
Bore Type	Cylindrical Bore
Configuration	Single Row
Bore Size	190 mm
Outside Diameter	340 mm
Width	55 mm
Fillet Radius/Chamfer	4 mm
Dynamic Load Rating	255,000 N
Static Load Rating	282,000 N

6238 Bearing 2D drawings and 3D CAD models



NACHI BEARINGS TRAINING INDUSTRY

Limiting Speed - Grease	1,800 rpm
Limiting Speed - Oil	2,100 rpm
Factor f_0	15.1
Radial Clearance	0.025 to 0.071 mm
d_a (min)	208 mm
D_a (max)	322 mm
r_a (max)	3 mm