

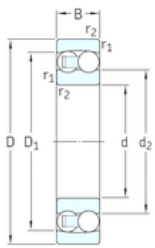

# NACHI BEARINGS TRAINING INDUSTRY



Cylindrical bore



Tapered bore

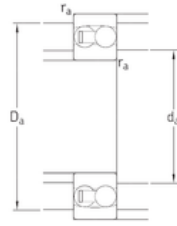

25 mm x 62 mm x 17 mm SKF 1305ETN9 self aligning ball bearings

Bearing No. 1305ETN9

1305ETN9 Bearing 2D drawings and 3D CAD models

Size	25x62x17 mm
Bore Diameter	25 mm
Outer Diameter	62 mm
Width	17 mm
d	25 mm
D	62 mm
B	17 mm
C	17 mm
d2	37,8 mm
r1 min.	1,1 mm
r2 min.	1,1 mm
D1	52,5 mm
da min.	32 mm
Da max.	55 mm
ra max.	1,1 mm
Weight	0,26 Kg
Basic dynamic load rating (C)	19 kN
Basic static load rating (C0)	5,4 kN
Fatigue load limit (Pu)	0,28
Reference speed	22000 r/min
Limiting speed	15000 r/min
Calculation factor (e)	0,28
Calculation factor (kr)	0,04
Calculation factor (Y0)	2,5
Calculation factor (Y1)	2,2



# NACHI BEARINGS TRAINING INDUSTRY