

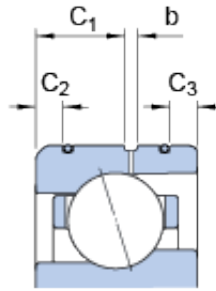

NACHI BEARINGS TRAINING INDUSTRY

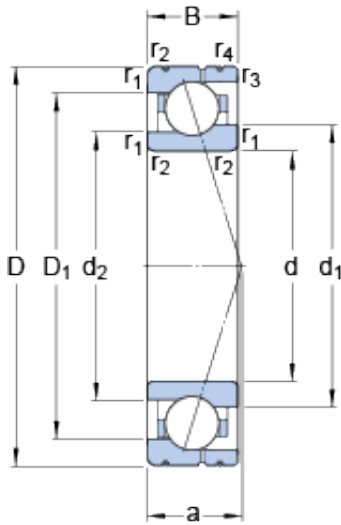

30 mm x 47 mm x 9 mm SKF 71906
CE/HCP4AL angular contact ball bearings

Bearing No. 71906 CE/HCP4AL

71906 CE/HCP4AL Bearing 2D drawings and 3D CAD models

Size	47x30x9 mm
Bore Diameter	47 mm
Outer Diameter	30 mm
Width	9 mm
d	30 mm
D	47 mm
B	9 mm
d ₁	35.8 mm
d ₂	34.4 mm
D ₁	41.39 mm
b	1.5 mm
C ₁	4.6 mm
C ₂	1.4 mm
C ₃	0.9 mm
r _{1,2} - min.	0.3 mm
r _{3,4} - min.	0.15 mm
a	10.1 mm
d _a - min.	32 mm
d _b - min.	32 mm
D _a - max.	45 mm
D _b - max.	46.2 mm
r _a - max.	0.3 mm
r _b - max.	0.15 mm
d _n	36.8 mm



NACHI BEARINGS TRAINING INDUSTRY

Basic dynamic load rating - C	5.6 kN
Basic static load rating - C ₀	3.2 kN
Fatigue load limit - P _u	0.14 kN
Limiting speed for grease lubrication	49000 r/min
Limiting speed for oil lubrication	75000 mm/min
Ball - D _w	4.762 mm
Ball - z	18
G _{ref}	0.6 cm ³
Calculation factor - f ₀	8.3
Preload class A - G _A	30 N
Preload class B - G _B	90 N
Preload class C - G _C	180 N
Calculation factor - f	1.08
Calculation factor - f	1
Calculation factor - f _{2A}	1
Calculation factor - f _{2B}	1.05
Calculation factor - f _{2C}	1.09
Calculation factor - f _{HC}	1.01
Preload class A	25 N/micron
Preload class B	39 N/micron
Preload class C	54 N/micron
d ₁	35.8 mm
d ₂	34.4 mm
D ₁	41.39 mm
C ₁	4.6 mm
C ₂	1.4 mm
C ₃	0.9 mm
r _{1,2} min.	0.3 mm



NACHI BEARINGS TRAINING INDUSTRY

$r_{3,4}$ min.	0.15 mm
d_a min.	32 mm
d_b min.	32 mm
D_a max.	45 mm
D_b max.	46.2 mm
r_a max.	0.3 mm
r_b max.	0.15 mm
d_n	36.8 mm
Basic dynamic load rating C	5.59 kN
Basic static load rating C_0	3.25 kN
Fatigue load limit P_u	0.14 kN
Attainable speed for grease lubrication	49000 r/min
Attainable speed for oil-air lubrication	75000 r/min
Ball diameter D_w	4.762 mm
Number of balls z	18
Reference grease quantity G_{ref}	0.6 cm ³
Preload class A G_A	30 N
Static axial stiffness, preload class A	25 N/ μ m
Preload class B G_B	90 N
Static axial stiffness, preload class B	39 N/ μ m
Preload class C G_C	180 N
Static axial stiffness, preload class C	54 N/ μ m
Calculation factor f	1.08
Calculation factor f_1	1
Calculation factor f_{2A}	1
Calculation factor f_{2B}	1.05
Calculation factor f_{2C}	1.09
Calculation factor f_{HC}	1.01



NACHI BEARINGS TRAINING INDUSTRY

Calculation factor f_0	8.3
Mass bearing	0.045 kg