

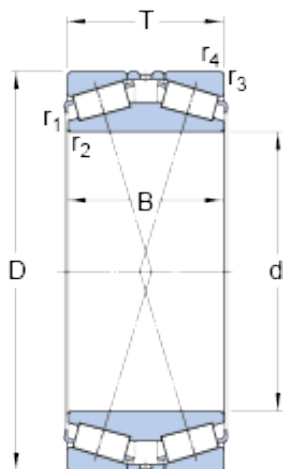

NACHI BEARINGS TRAINING INDUSTRY



609.6 mm x 820 mm x 171.45 mm SKF BT2B
332424/HA3 tapered roller bearings

Bearing No. BT2B 332424/HA3

BT2B 332424/HA3 Bearing 2D drawings and 3D CAD models

Size	820x609.6x171.45 mm
Bore Diameter	820 mm
Outer Diameter	609,6 mm
Width	171,45 mm
d	609.6 mm
D	820 mm
T	171.45 mm
B	171.45 mm
$r_{1,2}$ - min.	3.3 mm
$r_{3,4}$ - min.	6.4 mm
Basic dynamic load rating - C	4020 kN
Basic static load rating - C_0	10600 kN
Fatigue load limit - P_u	750 kN
Comparative radial load rating - C_F	980 kN
Comparative axial load rating - C_{Fa}	354 kN
Thrust factor - K	1.58
Calculation factor - e	0.37
Calculation factor - Y_1	1.8
Calculation factor - Y_2	2.7
Calculation factor - Y_0	1.8
Mass bearing	265 kg
Design variant/feature	TDI/GWIY2



NACHI BEARINGS TRAINING INDUSTRY

d_1	646 mm
D_1	721 mm
$r_{1,2}$ min.	3.3 mm
$r_{3,4}$ min.	6.4 mm
Basic dynamic load rating C	4020 kN
Basic static load rating C_0	10600 kN
Fatigue load limit P_u	750 kN
Calculation factor e	0.37
Calculation factor Y_1	1.8
Calculation factor Y_2	2.7
Calculation factor Y_0	1.8
Comparative radial load rating C_F	980 kN
Comparative axial load rating C_{Fa}	354 kN
Thrust factor K	1.58