

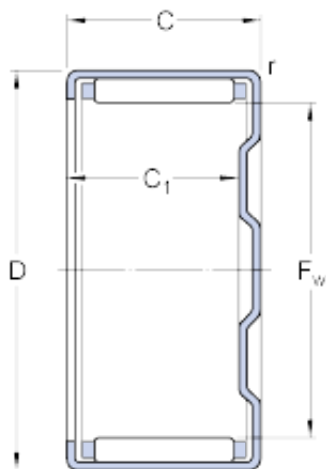

NACHI BEARINGS TRAINING INDUSTRY



BK 4020 Bearing 2D drawings and 3D CAD models

SKF BK 4020 cylindrical roller bearings

Bearing No. BK 4020

Size	47x40x20 mm
Bore Diameter	47 mm
Outer Diameter	40 mm
Width	20 mm
F_w	40 mm
D	47 mm
C	20 mm
C_1 - min.	17.3 mm
r - min.	0.8 mm
Basic dynamic load rating - C	24.2 kN
Basic static load rating - C_0	53 kN
Fatigue load limit - P_u	6.4 kN
Reference speed	6300 r/min
Limiting speed	7000 r/min
Mass bearing	0.062 kg
Inner ring IR series	IR 35x40x20.5
Inner ring LR series	LR 35x40x20.5
Radial shaft seal with a low cross-sectional height, single lip	G 40x47x4
Category	Bearings
Inventory	0.0
Manufacturer Name	SKF
Minimum Buy Quantity	N/A
Weight / Kilogram	0.062
Product Group	B04144



NACHI BEARINGS TRAINING INDUSTRY

F_w	40 mm
C_1 min.	17.3 mm
r min.	0.8 mm
Basic dynamic load rating C	24.2 kN
Basic static load rating C_0	53 kN
Fatigue load limit P_u	6.4 kN
Designation bearing	BK 4020
Radial shaft seal with a low cross-sectional height, double lip	SD 40x47x4