

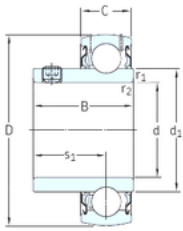

# NACHI BEARINGS TRAINING INDUSTRY

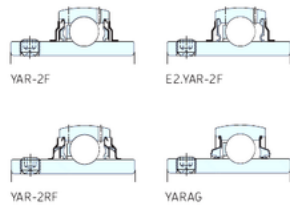

YAT



50 mm x 90 mm x 51,6 mm SKF YAR210-2RF deep groove ball bearings

Bearing No. YAR210-2RF

Size	50x90x51.6 mm
Bore Diameter	50 mm
Outer Diameter	90 mm
Width	51,6 mm
d	50 mm
D	90 mm
B	51,6 mm
C	22 mm
d1	62,5 mm
r1 min.	1 mm
r2 min.	1 mm
s1	32,6 mm
Weight	0,69 Kg
Basic dynamic load rating (C)	35,1 kN
Basic static load rating (C0)	23,2 kN
Fatigue load limit (Pu)	0,98

YAR210-2RF Bearing 2D drawings and 3D CAD models