

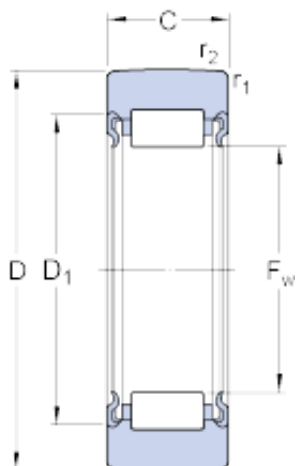

NACHI BEARINGS TRAINING INDUSTRY



SKF RNA 2207.2RS cylindrical roller bearings

Bearing No. RNA 2207.2RS

| | |
|--|---------------|
| Size | 42x72x22.7 mm |
| Bore Diameter | 42 mm |
| Outer Diameter | 72 mm |
| Width | 22,7 mm |
| D | 72 mm |
| F_w | 42 mm |
| C | 22.7 mm |
| D_1 | 50 mm |
| $r_{1,2}$ - min. | 1.1 mm |
| Basic dynamic load rating - C | 22.4 kN |
| Basic static load rating - C_0 | 35.5 kN |
| Fatigue load limit - P_u | 4.3 kN |
| Maximum dynamic radial loads - F_r | 38 kN |
| Maximum static radial loads - F_{0r} | 54 kN |
| Limiting speed | 2200 r/min |
| F_w | 42 mm |
| D_1 | 50 mm |
| $r_{1,2}$ min. | 1.1 mm |
| Basic dynamic load rating C | 22.4 kN |
| Basic static load rating C_0 | 35.5 kN |
| Fatigue load limit P_u | 4.3 kN |
| Maximum dynamic radial load F_r max. | 38 kN |
| Maximum static radial load | 54 kN |

RNA 2207.2RS Bearing 2D drawings and 3D CAD models



NACHI BEARINGS TRAINING INDUSTRY

| | |
|---------------------|---------|
| F_{0r} max. | |
| Mass support roller | 0.43 kg |